



INFANT CAR SEAT ADAPTER INSTRUCTIONS

Single

NOTE: Please ensure that you read and understand these instructions and also follow the instructions in the user guide for your BOB stroller and the instructions for your infant carrier. If you have any question, please visit www.britaxbob.com.au or contact your retailer or BRITAX Customer Service on 1300 303 330 before use.

This product is exclusively designed to work with BOB single strollers (Revolution SE, Revolution CE, IRONMAN or Sport Utility Stroller) strollers in combination with the ①BRITAX Safe-n-Sound Unity Infant Carrier with BOB fashion and ②BRITAX Safe-n-Sound Unity Infant Carrier (2010 standard only) plus BRITAX Click&Go® Adaptors(sold separately). Please save these instructions for future use.

⚠ WARNINGS ⚠

FAILURE TO FOLLOW THESE WARNINGS AND INSTALLATION INSTRUCTIONS COULD RESULT IN SERIOUS INJURY OR DEATH.

- Always ensure that the infant carrier/travel system adaptor is properly locked into place.
- Always ensure that the Click&Go® Adaptors of your infant carrier is properly connected to the infant carrier/travel system adaptor when installed on the stroller. For more information, see the relevant pages in their respective user guides.
- Do not jog or run with an infant carrier.

INSTALLATION INSTRUCTIONS

Installing ICSA

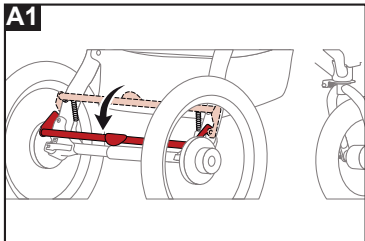
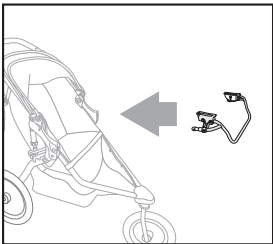

A1: Prepare Stroller Set parking brake (see stroller owner's manual if necessary).

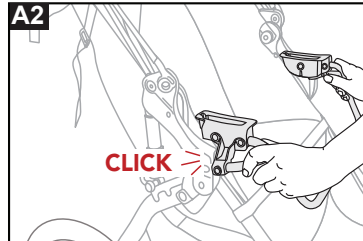

A2: Slide Covers Down Push to slide each cover down (at front of stroller Accessory Adapter) on both sides of stroller, exposing each Receiver Socket.

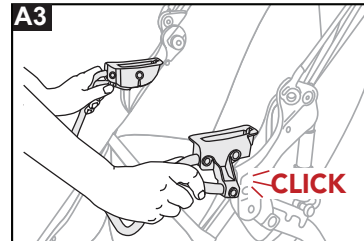

Align and insert each Locking End Cap on ICSA into the respective Accessory Adapter Receiver Socket. Compress one Locking Plunger into the corresponding Receiver Socket until an audible "click" is heard.

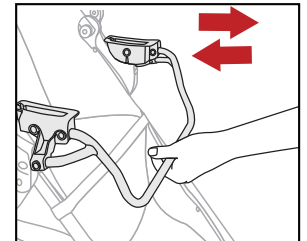

A3: Compress Locking Plunger on the opposite side of the stroller into the corresponding Receiver Socket until an audible "click" is heard.

Verify Proper Attachment Pull on ICSA to verify it is securely locked into place.

Removing ICSA

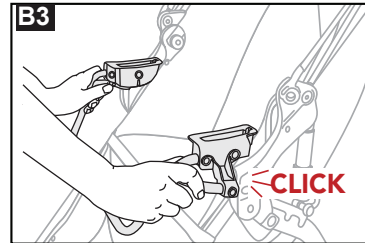
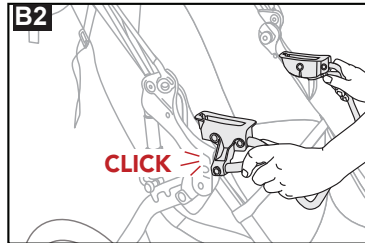
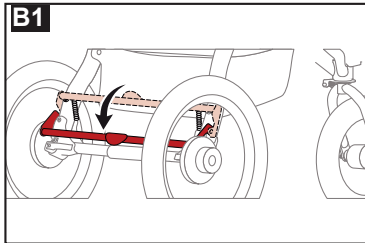
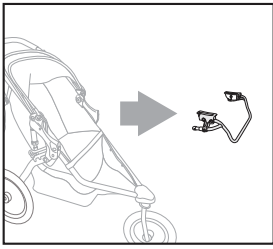

B1: Prepare Stroller Set parking brake (see stroller owner's manual if necessary).

B2: Remove ICSA Depress the Red Release Button of the Accessory Adapter on one side of the stroller to release the Locking Plunger.

If the Locking Plunger does not release automatically, gently pull the exposed end while depressing the red lever until the Locking End Cap is clear of the Receiver Socket.

B3: Depress the Red Release Button of the Accessory Adapter on the opposite side of the stroller to release the Locking Plunger.

If the Locking Plunger does not release automatically, gently pull the exposed end while depressing the red lever until the Locking End Cap is clear of the Receiver Socket.

BOB, BOB Strollers, Stroller Strides, Revolution, BOB Gear and the BOB device are the property of Britax Childcare Holding Limited (UK)

BOB Gear® by Britax

BRITAX CHILDCARE PTY. LTD

A Britax International Company.

(Incorporated in Victoria)

A.B.N. 55 006 773 600

99 Derby Road ,Sunshine, Victoria 3020, Australia

Telephone: (03) 9288 7288

Fax: (03) 9311 5798

©2010 Copyright Britax Childcare Pty. Ltd. Australia

and Britax Child Safety Inc. USA

www.britaxbob.com.au